

# G80

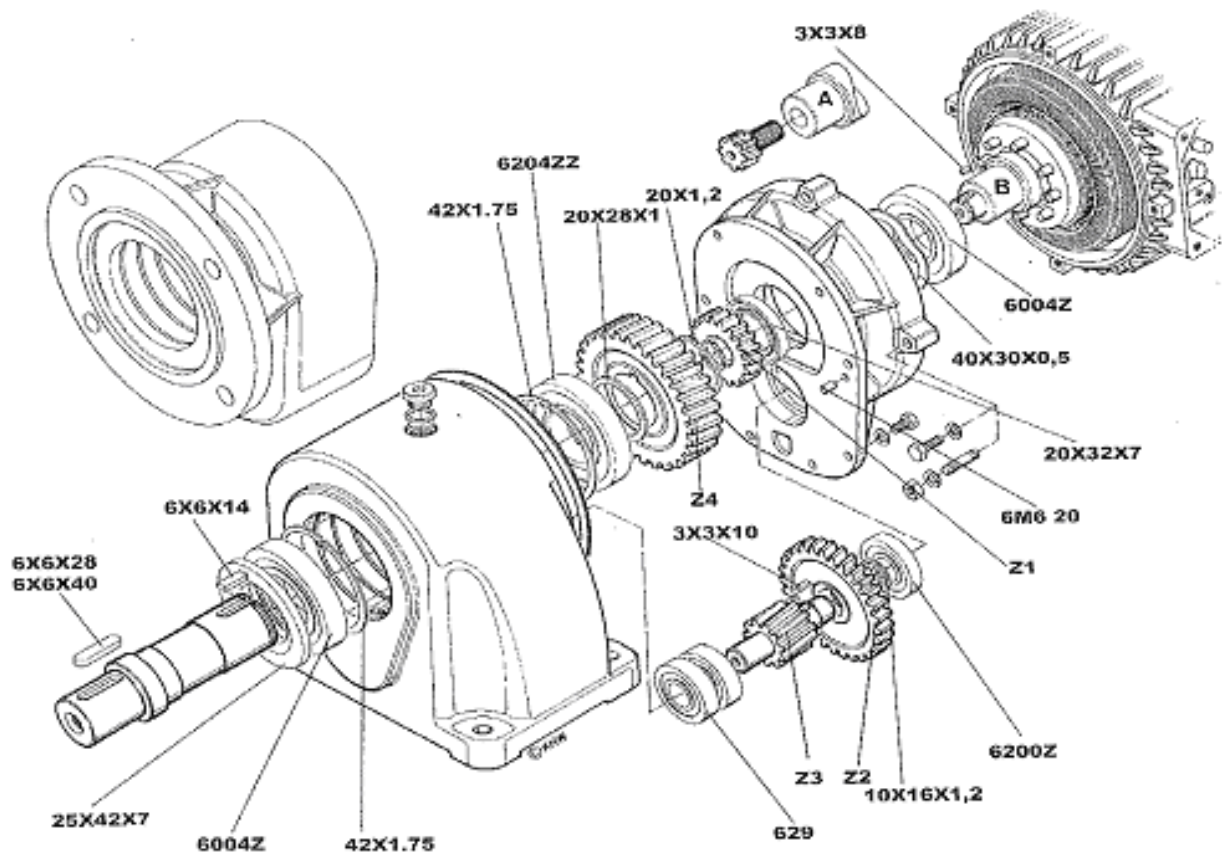

## Drevsatser

### Z1/Z2

B22/30 - 1.25	504798101/504798201
B13/39 - 1.25	504798102/504798202
B15/37 - 1.25	504798103/504798203
A11/57 - 1.0	504798301/504798401
A13/55 - 1.0	504798302/504798402
A14/54 - 1.0	504798303/504798403
A10/73 - 0.8	504798501/504798601
A12/71 - 0.8	504798502/504798602
A12/106 - 0.6	504798701/504798801
B17/36 - 1.25	505021901/505022001

### Z3/Z4

12/77 - 0.8	504770701/504770801
13/58 - 1.0	504770901/504770001
13/76 - 0.8	504770702/504770802
16/55 - 1.0	504770902/504771002
19/52 - 1.0	504770903/504771003
23/48 - 1.0	504770904/504771004
25/46 - 1.0	504770905/504771005

Utgående axel(mm): 20 x 36 alt. 20 x 50  
 Flänslagerhus: ytterdiameter(mm) 120 alt. 140 alt. 160  
 Fothus: Mått till axelcentrum 80mm