

## ◆ PILLOW BLOCKS

### MUCP200

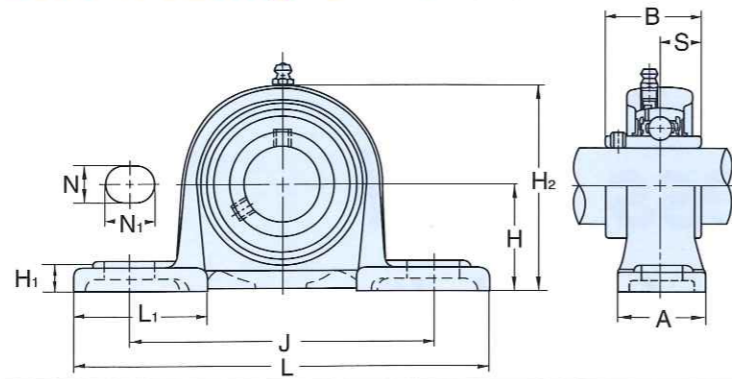

Shaft Dia. (mm)	Unit No.	Dimensions (mm)											Bolt Size	Bearing			Housing No.	Weight (kg)
		H	L	J	A	N	N <sub>1</sub>	H <sub>1</sub>	H <sub>2</sub>	L <sub>1</sub>	B	S		Bearing No.	Basic Load Rating (N)			
20	MUCP204	33.3	127	95	30	13	19	9	64	42	31	12.7	M10	MUC204	10900	5300	MP204	0.5
25	MUCP205	36.5	140	105	30	13	19	10	70	42	34.1	14.3	M10	MUC205	11900	6300	MP205	0.65
30	MUCP206	42.9	165	121	36	17	21	11	82	53	38.1	15.9	M14	MUC206	16700	9050	MP206	0.95
35	MUCP207	47.6	167	127	38	17	21	12	92	54	42.9	17.5	M14	MUC207	22000	12300	MP207	1.25
40	MUCP208	49.2	184	137	40	17	22	12	98	52	49.2	19	M14	MUC208	24900	14300	MP208	1.5
45	MUCP209	54	190	146	40	17	22	13	105	60	49.2	19	M14	MUC209	28100	16400	MP209	1.75
50	MUCP210	57.2	206	159	45	20	25	14	112	65	51.6	19	M16	MUC210	30200	18600	MP210	2.05

## ◆ FOUR-BOLT FLANGE UNITS

### MUCF200

Please consult us for availability of MUCF200 type with the bore 35mm and over.

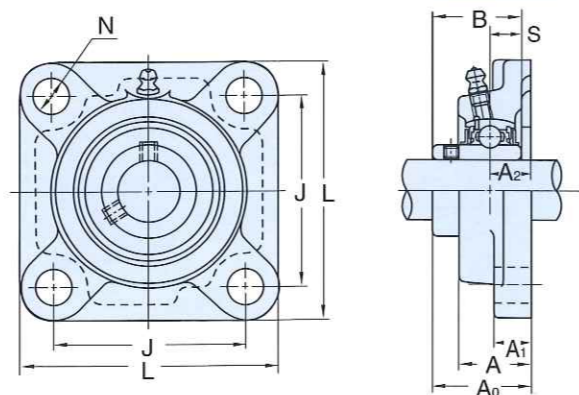

Shaft Dia. (mm)	Unit No.	Dimensions (mm)										Bolt Size	Bearing			Housing No.	Weight (kg)
		L	J	A <sub>2</sub>	A <sub>1</sub>	A	N	A <sub>0</sub>	B	S	Bearing No.		Basic Load Rating (N)				
20	MUCF204	86	64	15	11	25.5	12	33.3	31	12.7	M10	MUC204	10900	5300	MF204	0.65	
25	MUCF205	95	70	16	13	27	12	35.7	34.1	14.3	M10	MUC205	11900	6300	MF205	0.9	
30	MUCF206	108	83	18	13	31	12	40.2	38.1	15.9	M10	MUC206	16700	9050	MF206	1.2	
35	MUCF207	117	92	19	15	34	14	44.4	42.9	17.5	M12	MUC207	22000	12300	MF207	1.6	
40	MUCF208	130	102	21	15	36	16	51.2	49.2	19	M14	MUC208	24900	14300	MF208	2.15	
45	MUCF209	137	105	22	16	38	16	52.2	49.2	19	M14	MUC209	28100	16400	MF209	2.55	
50	MUCF210	143	111	22	16	40	16	54.6	51.6	19	M14	MUC210	30200	18600	MF210	2.65	

## ◆ TWO-BOLT FLANGE UNITS

### MUCFL200

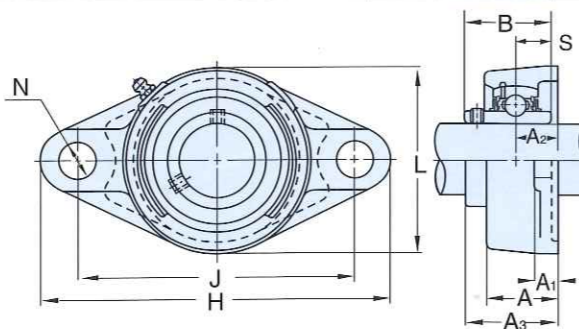

Shaft Dia. (mm)	Unit No.	Dimensions (mm)										Bolt Size	Bearing			Housing No.	Weight (kg)
		H	J	A <sub>2</sub>	A <sub>1</sub>	A	N	L	A <sub>3</sub>	B	S		Bearing No.	Basic Load Rating (N)			
20	MUCFL204	113	90	15	10	25.5	12	60	33.3	31	12.7	M10	MUC204	10900	5300	MFL204	0.35
25	MUCFL205	130	99	16	10	27	16	68	35.7	34.1	14.3	M14	MUC205	11900	6300	MFL205	0.5
30	MUCFL206	148	117	18	10	31	16	80	40.2	38.1	15.9	M14	MUC206	16700	9050	MFL206	0.8
35	MUCFL207	161	130	19	11	34	16	90	44.4	42.9	17.5	M14	MUC207	22000	12300	MFL207	1.05
40	MUCFL208	175	144	21	11	36	16	100	51.2	49.2	19	M14	MUC208	24900	14300	MFL208	1.35
45	MUCFL209	188	148	22	13	38	19	108	52.2	49.2	19	M16	MUC209	28100	16400	MFL209	1.65
50	MUCFL210	197	157	22	13	40	19	115	54.6	51.6	19	M16	MUC210	30200	18600	MFL210	1.9

## ◆ TAKE-UP

### MUCT200

Please consult us for availability of MUCT200 type with the bore 35mm and over.

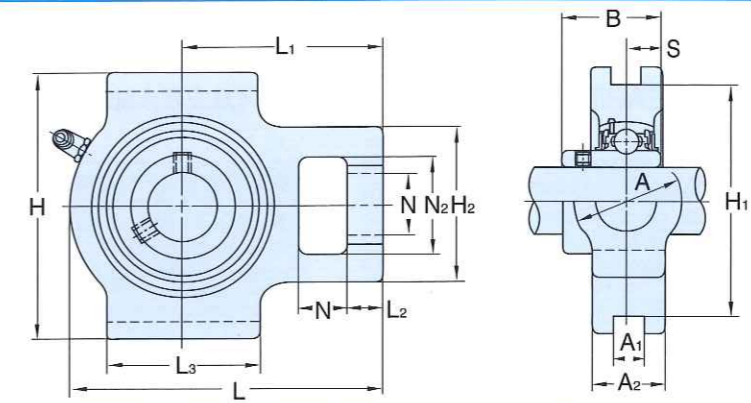

Shaft Dia. (mm)	Unit No.	Dimensions (mm)															Bearing			Housing No.	Weight (kg)
		N <sub>1</sub>	L <sub>2</sub>	H <sub>2</sub>	N <sub>2</sub>	N	L <sub>3</sub>	A <sub>1</sub>	H <sub>1</sub>	H	L	A <sub>2</sub>	A	L <sub>1</sub>	B	S	Bearing No.	Basic Load Rating (N)			
20	MUCT204	16	12	51	32	19	51	12	76	89	94	21	32	61	31	12.7	MUC204	10900	5300	MT204	0.8
25	MUCT205	16	12	51	32	19	51	12	76	89	97	24	32	62	34.1	14.3	MUC205	11900	6300	MT205	0.9
30	MUCT206	16	12	56	37	22	57	12	89	102	113	28	37	70	38.1	15.9	MUC206	16700	9050	MT206	1.4
35	MUCT207	16	15	64	37	22	64	12	89	102	129	30	37	78	42.9	17.5	MUC207	22000	12300	MT207	1.7
40	MUCT208	19	18	83	49	29	83	16	102	114	144	33	49	88	49.2	19	MUC208	24900	14300	MT208	2.6
45	MUCT209	19	18	83	49	29	83	16	102	117	145	35	49	87	49.2	19	MUC209	28100	16400	MT209	2.55
50	MUCT210	19	18	83	49	29	86	16	102	117	151	37	49	90	51.6	19	MUC210	30200	18600	MT210	2.65

## ◆ BALL BEARINGS

### MUC200 C4HR20

Note ; (※) Also available ; Bearings with inch sized bores. Please consult us.

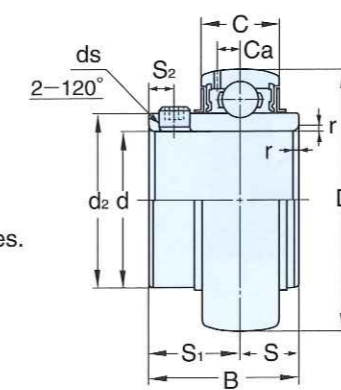

Shaft Dia. (mm)	Unit No.	Dimensions (mm)												Basic Load Rating (N)		Weight (kg)
		d	D	B	C	r	S	S <sub>1</sub>	S <sub>2</sub>	ds	Ca	d <sub>2</sub>	Cr	Cor		
20	MUC204	20	47	31	17	1.5	12.7	18.3	4.5	M6 × 1	4.5	29	10900	5300	0.16	
25	MUC205	25	52	34.1	17	1.5	14.3	19.8	5	M6 × 1	4.5	34	11900	6300	0.19	
30	MUC206	30	62	38.1	19	1.5	15.9	22.2	5	M6 × 1	5.1	40.5	16700	9050	0.31	
35	MUC207	35	72	42.9	20	2	17.5	25.4	6	M8 × 1	5.8	48	22000	12300	0.48	
40	MUC208	40	80	49.2	21	2	19	30.2	8	M8 × 1	6.2	53	24900	14300	0.62	
45	MUC209	45	85	49.2	22	2	19	30.2	8	M8 × 1	6.5	57.3	28100	16400	0.67	
50	MUC210	50	90	51.6	23	2	19	32.6	9	M10 × 1.25	6.5	63	30200	18600	0.78	

## ◆ MATERIALS AND OPERATIONAL TEMPERATURE

Descriptions	Standard series	FD-grease filled (★) high temperature series
	Bearing rings Steel ball	Stainless Steel - SUS440C
Slinger Retainer Set-screw	Stainless Steel - SUS304	
Seal	Nitril	Silicon
Grease	Alvania grease 3	FD-grease
Range of operating temperature	-20 ~ +120°C	-20 ~ +200°C
Housing	Stainless cast steel - SCS13	

(★) FD-grease : Authorized and accepted by USDA (United States Department of Agriculture) and approved as USDA H-1 grade grease.

Remark : To specify, add suffix "C4HR20" to bearing unit number for food processing machinery and high temperature application. Please be careful, however, for the grease not to touch food directly.