

G112

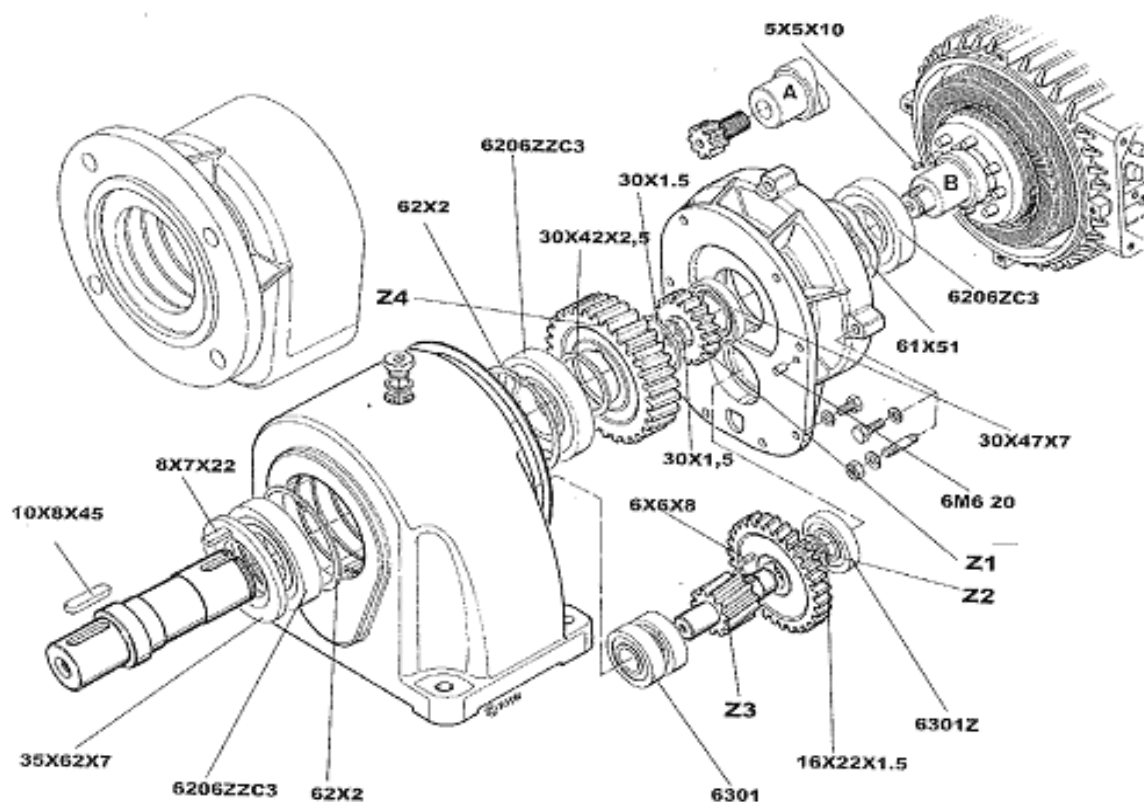

Drevsatser

Z1/Z2

| | |
|---------------|---------------------|
| A10/93 - 1.0 | 504802301/504802401 |
| A11/64 - 1.25 | 504802501/504802601 |
| A12/91 - 1.0 | 504802302/504802402 |
| A13/50 - 1.5 | 504802701/504802801 |
| A13/62 - 1.25 | 504799601/504802602 |
| A15/48 - 1.5 | 504799802/504802802 |
| B16/37 - 1.75 | 504802901/504803001 |
| B17/36 - 1.75 | 504802902/504803002 |
| B17/46 - 1.5 | 504802703/504802803 |
| B20/33 - 1.75 | 504802903/504803003 |
| B21/32 - 1.75 | 504802904/504803004 |
| B22/41 - 1.5 | 504802704/504802804 |
| B22/31 - 1.75 | 504802905/504803005 |
| B23/30 - 1.75 | 504802906/504803006 |

Z3/Z4

| | |
|--------------|---------------------|
| 12/70 - 1.25 | 504772101/504772201 |
| 13/69 - 1.25 | 504772102/504772202 |
| 19/63 - 1.25 | 504772103/504772203 |
| 22/60 - 1.25 | 504772104/504772204 |

Utgående axel(mm): 30 x 58 alt. 30 x 80
 Flänslagerhus: ytterdiameter(mm) 160 alt. 200 alt. 25
 Fothus: Avstånd till axelcentrum 112 mm